

Pauluhn ECOS EHAR linear fluorescent luminaires

Type 4X, IP66

5L

For use in harsh environments

Applications:

- Harsh and heavy industrial
- Food and beverage
- Pulp and paper
- Wastewater treatment

Features:

- UV stabilized, impact-resistant fiberglass-reinforced polyester housing
- Shock- and vibration-resistant lamp holders reduce premature lamp failure
- Available in two and four foot lengths
- T8, T5, T5HO lamps in 1-, 2- or 3-lamp configurations
- Ceiling, wall and pipe clamp
- Eye bolts
- Tool-less entry for ease of installation
- Up to three gland entries at each end, suitable for dead end, through feed or single-ended "T" wiring
- Lens is removable at 120°, allowing for narrow gap mounting between obstructions

Electrical ratings:

- 120-277 VAC, 50/60 Hz
- Optional emergency battery back-up ballast (self-contained 90 minute minimum with LED charge status indicator for all lamp types)



Temperature performance data:

Lamp watts (2 ft. / 4 ft.)	Ballast / socket type	ANSI lamp code	Supply wire °C
14/28	T5 mini bi-pin G5	F14 / F28-T5	90
24/54	T5HO mini bi-pin G5	F24 / F54-T5HO	90
17/32	T8 bi-pin G13	F17 / 32-T8	90
17/32	T8 bi-pin G13	F17 / 32-T8	90
18/36	T8 bi-pin G13	F18 / 36-T8	90

Dimensions:

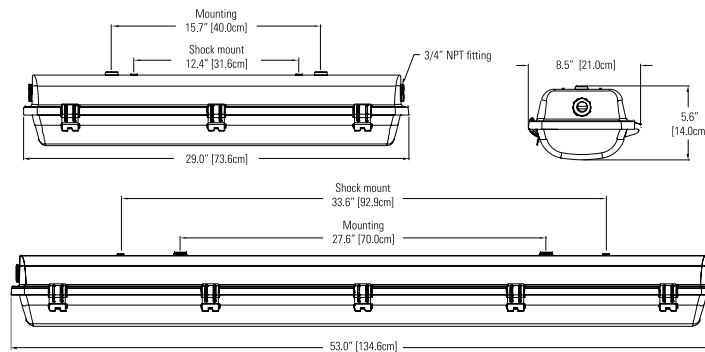

Certifications and compliances:

- UL924 – Emergency Lighting Equipment
- UL1598 – Luminaires
- cUL
- ABS
- Type 4X
- IP66
- Enclosed and gasketed

Standard materials:

- Housing – fiberglass-reinforced polyester
- Lens – injection molded polycarbonate
- Reflector – engineered plastic
- Gaskets – silicone
- Latches – engineered plastic (standard); stainless steel (optional)
- Lamp holders – polycarbonate

Weights:

Model	Weight (lbs.)	Weight (kg.)
2 foot	9.0	4.0
4 foot	17.0	8.0

5L

Pauluhn ECOS EHAR

linear fluorescent luminaires

Type 4X, IP66

5L

For use in harsh environments

Ordering information:

Part number example

EHAR42174012L

EHAR 4 2 1 7 4 012 L

Length (nominal)

2	2 foot
4	4 foot

Number of lamps

1	1 lamp
2	2 lamps
3 ^A	3 lamps

Lamp types

1	2 ft. 17 or 4 ft. 32 T8 bi-pin
3	2 ft. 18 or 4 ft. 36 T8 bi-pin
5	2 ft. 24 or 4 ft. 54 T5HO bi-pin
6	2 ft. 14 or 4 ft. 28 T5 bi-pin

Voltage / frequency

7	120-277 VAC, 50/60 Hz
6	347 VAC, 60 Hz

Mounting options

1	Ceiling bracket, stainless steel
2	Wall mount cornice bracket
3	Pipe clamp bracket
4	Cable suspension eye bolts

Options

EM2	Emergency ballast, one lamp, 277V max.
EM3	Emergency ballast, high lumen, one lamp, 277V max.
EMT2	Emergency ballast, one lamp, 277V max., test switch
EMT3	Emergency ballast, high lumen, one lamp, 277V max., test switch
L	Lamps
S	Stainless steel latch
T	Terminal block, 5-pole
T2	Two terminal blocks, 5-pole, one on each end

Entry

012	Myers conduit hubs, zinc, 3/4" NPT, one entry at each end
022	Myers conduit hubs, zinc, 3/4" NPT, two entries at each end
112	Myers conduit hubs, stainless steel, 3/4" NPT, one entry at each end
122	Myers conduit hubs, stainless steel, 3/4" NPT, two entries at each end
712	3/4" NPT entry, one entry at each end
722	3/4" NPT entry, two entries at each end
733	3/4" NPT entry, three entries at each end

^AEmergency ballast not available with 2 ft., 3-lamp fixtures.

Pauluhn ECOS EHAR linear fluorescent luminaires

Type 4X, IP66

5L

For use in harsh environments

Mounting options:

Ceiling mount (ECO1091MTK)

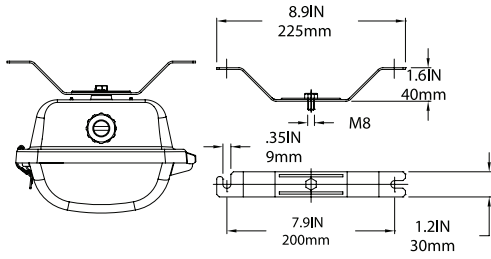

Cable suspension eye bolts (ECOEBKIT)

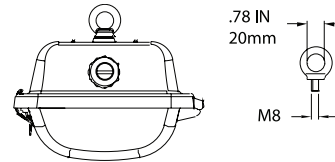

Pipe clamp bracket (ECOPMKT)

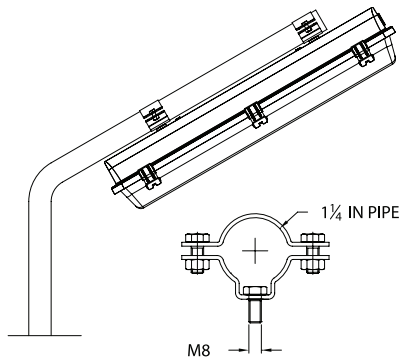

Wall mount (ECOWMKT)

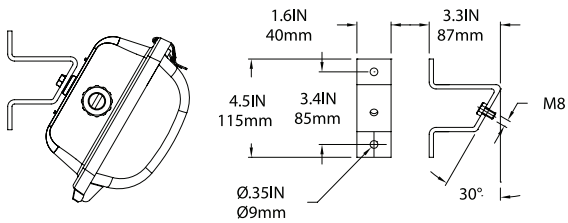

5L